

### Let's begin your collection!

Follow these steps to collect your sample.  
If you have any questions, contact us for help:

1-800-257-2370

### First time using Tasso?



Watch our instructional video:  
[www.tassoinc.com/tile-t20-kit-video](http://www.tassoinc.com/tile-t20-kit-video)

or scan the QR code  
to access the video.



### Additional Supplies



Timer



Mirror



Pen



Razor

1

## Prepare

### Step 1

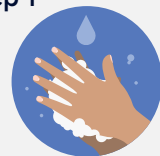

Wash hands before use. Healthcare workers must wear gloves during collection.

### Step 2

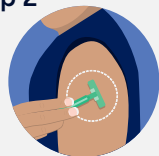

Identify collection site on upper arm – for best results remove any hair.

### Step 3

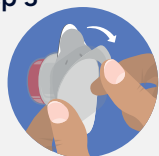

Remove all items from the box and remove the device from its package. Device is single-use - DO NOT push button yet.

### Step 4

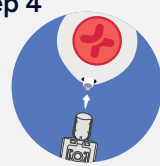

Connect the Tile to the device by pressing until snug. Your device might be a different color than shown.

### Step 5

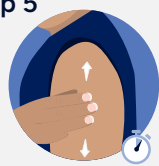

Rub hand up and down upper arm **quickly and firmly** for 30 seconds to warm and increase blood flow.

### Step 6

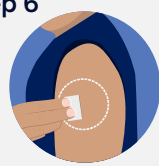

Clean area with alcohol pad and allow to dry.

### Step 7



Remove clear cover from button. DO NOT push the button until device is stuck to shoulder.

2

## Collect

### Step 8



Peel tab away from button and stick device to warmed area with the Tile pointing down. Hang arm straight down at side.

### Step 9

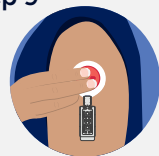

Press button down flush with the device, hold for 1 second and release. Blood may not appear for first 1-2 minutes.

### Step 10

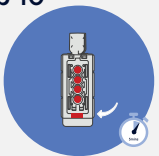

You may not feel the device.

Start a 5-minute timer. Watch Tile fill using mirror. Remove device when blood fills all 4 dots and reaches the bottom of the Tile which may happen quickly.

### Step 11



Remove device by peeling from one side. Apply bandage vertically and add slight pressure.

### Step 12

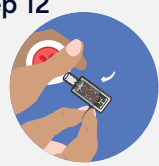

Peel off the clear film on the front of the Tile to expose the vents for drying.

### Step 13

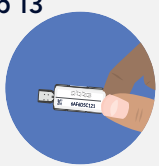

If a barcode label is provided, apply label to the back of the Tile, opposite from the film side.

3

## Ship

### Step 14

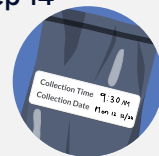

Record time and date on the return bag label.

### Step 15

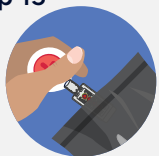

Place device with Tile attached in the foil return bag and seal. Leave the moisture packs in the bag.

### Step 16



Follow provided instructions to return sample to the lab.

### Step 17



Follow local guidelines for discarding all materials.

### Step 18

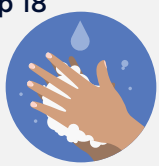

Wash hands after use.

